

# MAGNIFIQUE MEETINGS

SOFITEL  
LEGEND



Sofitel Legend The Grand Amsterdam is the perfect location for discreet board meetings to lavish banquets and from conferencing events to weddings. The Grand provides banqueting facilities in one of the most sought-after properties in the city centre of Amsterdam; offering premier conference facilities and the Magnifique Meetings™ concept, which combines the latest conference technology with excellent service and facilities.

## Former City Hall

The Grand boasts nineteen meeting rooms and banqueting halls in total, covering 1400 m<sup>2</sup> (15.070 ft). Five of these rooms are listed as historical monuments and were taken into use when The Grand formerly served as City Hall of Amsterdam: the Council Chamber, the Burgomaster and Aldermans Chamber, the St. Cecilia and the beautiful First Class Marriage Chamber. These historic rooms boast natural daylight, canal or garden view and all have a different magnifique story.

## Princenhof

The Princenhof, once functioning as accommodation for, amongst others, Prince William of Orange and the French Queen Maria de Medici, holds fourteen contemporary meeting rooms, all equipped with modern audio-visual facilities. It is the perfect venue for private meetings and conferencing events.

## Tailor-made banqueting

Dedicated to your event, the Magnifique Meeting™ planners will assist you in planning your event to the smallest details, to ensure a seamless service and stress-free experience.

Whether you are organising a board meeting or a private dinner, the Magnifique Meeting™ planners will plan your event into detail and work closely together with the Executive Chef of The Grand to not only provide you with the best accommodation and facilities, but also with a culinary menu that suits your wishes and preferences.

Additionally, award-winning restaurant Bridges features an exclusive private dining room that can accommodate up to 12 guests. Flooded with natural daylight and with pleasant views on one of Amsterdam's oldest canals, guests can enjoy a delicious dinner of Chef de Cuisine Raoul Meuwese and his team up to 8 courses.

## Magnifique facilities

Located between two historical canals in the heart of Amsterdam, The Grand boasts a rich history; from a 15th-century convent to royal lodgings, to Dutch Admiralty headquarters, to the City Hall of Amsterdam. The Grand offers five-star luxury in a unique 'Amsterdam' ambiance, furnished with French elegance and grandeur.

The Grand has 177 spacious rooms, including 52 luxury suites with Butler service. The Sofitel SPA offers a real escape from the hustle and bustle of the city, with special treatments, a heated indoor swimming pool and sauna facilities. The hotel features exclusive food & beverage facilities, such as award-winning restaurant Bridges, gardenbistro Oriole and the typical Dutch brown café The Flying Dutchman; ideal places to enjoy a wonderful lunch or dinner or to enjoy a drink at the end of the day.

Next to the on-site activities, The Grand can of course also assist in organising off-site activities, such as boat cruises and bike tours.

MAGNIFIQUE  
MEETINGS



HOTEL  
**THE GRAND**  
AMSTERDAM  
*Depuis 1578*

**Main building**

**Ground floor**

1. Entrance
2. Restaurant Bridges
3. Bridges, private dining
4. Bridges, Chef's Table
5. Gardenbistro Oriole
6. The Flying Dutchman
7. The Floral Designers

**Historical Meeting Rooms**

**First floor**

8. Alderman's Chamber
9. St. Cecilia Chamber
10. Burgomaster's Chamber
11. Marriage Chamber
12. Council Chamber
13. Balcony
14. Garden Terrace
15. Courtyard

**Princenhof meeting & convention centre**

**Princenhof meeting & convention centre**

**Ground floor**

16. Grand Duke
17. Grand Boardroom
18. Admiralty

**First floor**

19. King
20. Queen
21. Princess
22. Prince I
23. Prince II

**Second floor**

24. Earl
25. Count
26. Baron
27. Marquis
28. Lord

**Other**

- Elevator
- Toilets
- 29. Cloakroom



SOFITEL LEGEND THE GRAND AMSTERDAM

Oudezijds Voorburgwal 197, 1012 EX Amsterdam, The Netherlands  
+31 (0)20 555 33 39 - H2783 SB@sofitel.com



# Capacity Magnifique Meetings™ rooms

All rooms have air-conditioning / air-cooling, no pillars and natural daylight.

	L	W	H	M <sup>2</sup>	Ft <sup>2</sup>	Theatre	Cabaret/ Crescent PHS (5 pax/table)	Cabaret/ Crescent HS (6-8 pax/table)	Classroom	Square	U-Shape	Boardroom	Banquet	Cocktail
Council Chamber	21.7	13.6	4.7	295	3175	320	-	152	140	-	-	-	200	300
* Council Chamber I	13.6	13.0	4.7	177	1905	200	-	88	72	48	36	36	110	175
* Council Chamber II	14.0	8.7	4.2	122	1313	120	-	64	45	32	23	24	90	125
St. Cecilia Chamber	8.0	7.5	5.0	60	645	50	-	21	27	32	24	20	40	60
Aldermans Chamber	8.1	7.0	3.0	57	613	40	-	21	24	24	24	20	40	60
Burgomaster Chamber	8.2	5.3	3.0	43	462	30	-	-	18	-	-	20	30	40
Marriage Chamber	8.0	6.4	3.2	51	548	45	-	-	-	-	-	20	20	40
* Balcony	8.0	6.4	3.2	51	548	-	-	-	-	-	-	-	-	25
Admiralty	19.0	7.6	3.7	144	1550	110	56	-	-	-	-	-	100	150
Grand Boardroom	9.7	5.8	4.2	56	602	-	-	-	-	-	-	18	-	-
Grand Duke	6.7	5.9	3.6	39	419	30	14	-	12	16	12	12	20	30
Prince	19.4	8.0	3.3	155	1668	150	75	-	72	54	46	40	80	150
* Prince I	11.4	8.0	3.3	91	979	100	45	-	45	36	32	30	50	90
* Prince II	8.0	8.0	3.3	64	688	50	30	-	27	24	16	14	30	60
Queen	13.8	6.2	3.2	85	914	80	30	-	30	26	32	28	40	100
King	15.2	6.2	3.8	94	1011	80	30	-	30	26	32	28	40	100
Princess	17.4	6.0	2.8	104	1119	80	30	-	30	26	28	28	-	100
Lord	7.2	5.9	2.7	42	452	-	-	-	-	-	-	14 <sup>A</sup> /16 <sup>B</sup>	-	-
Marquis	6.0	4.7	2.7	28	301	-	-	-	-	-	-	8 <sup>A</sup> /10 <sup>B</sup>	-	-
Earl	6.0	4.7	2.8	28	301	-	-	-	-	-	-	5 <sup>A</sup> /8 <sup>B</sup>	-	-
Count	6.5	5.9	2.8	38	409	-	-	-	-	-	-	14 <sup>A</sup> /16 <sup>B</sup>	-	-
Baron	9.5	4.6	2.8	43	462	-	-	-	-	-	-	10 <sup>A</sup> /12 <sup>B</sup>	-	-
Foyer I	6.5	3.4	3.8	22	236	-	-	-	-	-	-	-	-	20
Foyer II	6.0	3.5	2.8	21	226	-	-	-	-	-	-	-	-	20

All figures based on new furniture, safety regulations

<sup>A</sup> with screen  
<sup>B</sup> without screen



Theatre



Cabaret/  
Crescent  
PHS



Cabaret/  
Crescent  
HS



Class-  
room



Square



U-shape



Board-  
room



Banquet

## Historical rooms

First floor

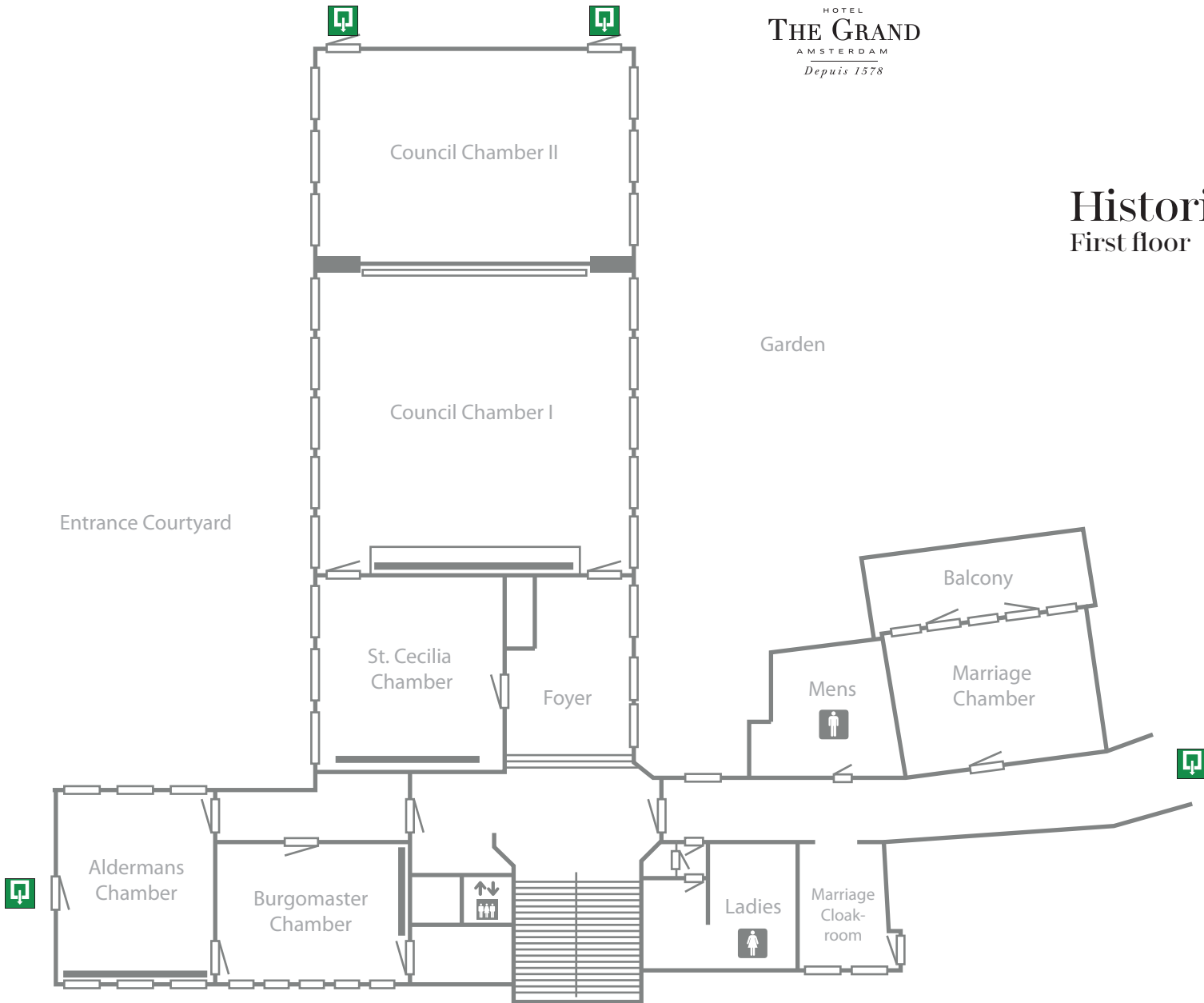

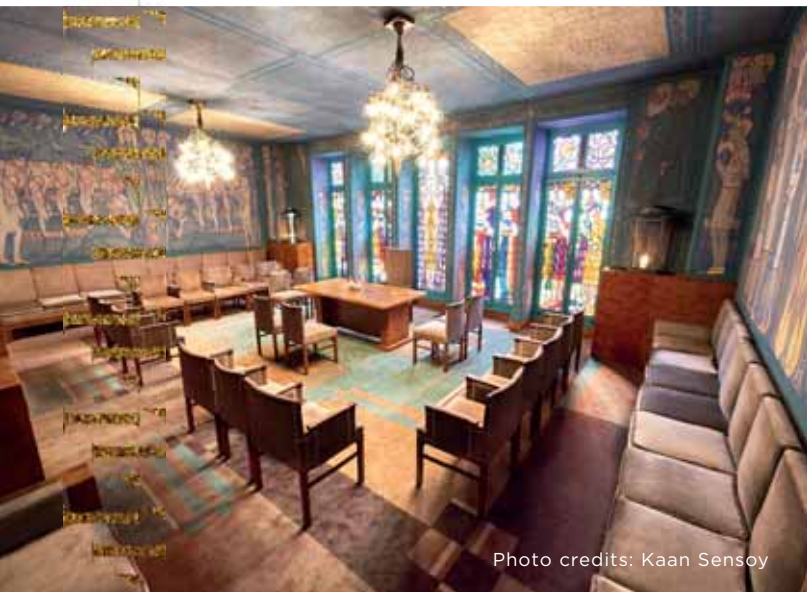

Photo credits: Kaan Sensoy



Main building - First floor



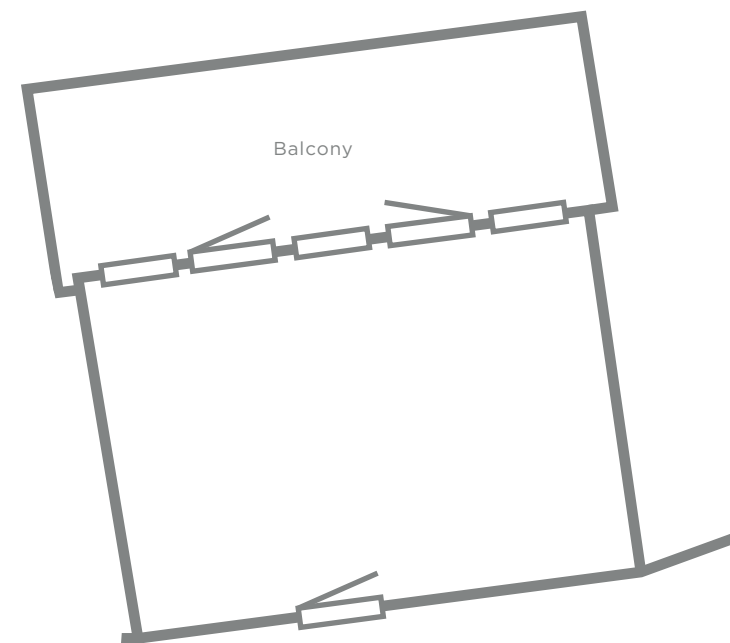

## Marriage Chamber

The Marriage Chamber is located on the first floor of the monumental wing of The Grand and is designed by artist Chris LeBeau, who completed this room in 1926. The Marriage chamber was used, amongst others, to celebrate royal weddings. The wall paintings, with unique colour combinations, in this room symbolize the story of love. From the balcony of the Marriage Chamber you can overlook the beautiful inner garden of The Grand. The Marriage chamber provides an elegant setting with a harmonious ode to marriage and love.

- Stained glass windows that can be opened
- Adjoining balcony (24 m<sup>2</sup>)
- Air-conditioned



### Dimensions & capacity

Surface (m <sup>2</sup> /ft <sup>2</sup> )	51/548				
Length (m)	8.0	Theatre	Banquet	Board-room	Cocktail
Width (m)	6.4				
Height (m)	3.2				
Marriage Chamber		45	20	20	40
Balcony		-	-	-	25

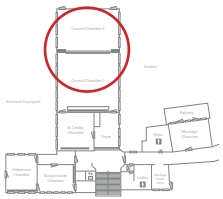

Main building - First floor

## Council Chamber

The Council Chamber was built in 1924 as the headquarters for Amsterdam's city council and is now listed as a historical monument. The Council Chamber is notable for its painted, engraved and carved wooden panels. In this setting our former Queen, Princess Beatrix, got married in 1966.

- Build in projection screen of 5,90 x 3,40 m
- Natural daylight
- Adjustable lightning and blinds
- Air-conditioned and windows that can be opened
- Fixed council table in front of the screen

### Dimensions & capacity

Surface (m <sup>2</sup> /ft <sup>2</sup> )	295/3175					
Length (m)	21.7	Theatre	Banquet	Crescent	Class-room	Cocktail
Width (m)	13.6					
Height (m)	4.7					
Council Chamber	320	200	152	140	300	
Council Chamber I	200	110	88	72	175	
Council Chamber II	120	90	64	45	125	

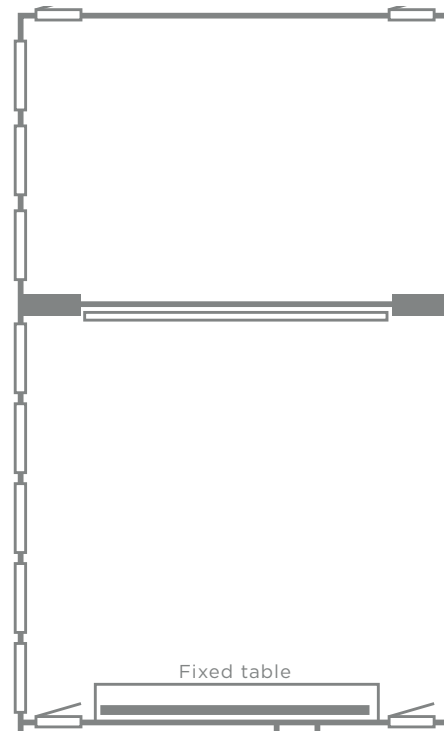





STAY



Main building - First floor

## St. Cecilia Chamber

The St. Cecilia Chamber is one of the historical meeting rooms located on the first floor and overlooks the courtyard of The Grand. It was previously used as one of the offices of the former city hall of Amsterdam. This square shaped historical meeting room is located right next to the Council Chamber and has remarkable high ceilings.

- Built-in projection screen of 2,40 x 1,75 m
- Natural daylight
- Adjustable lightning and blinds
- Air-conditioned and windows that can be opened

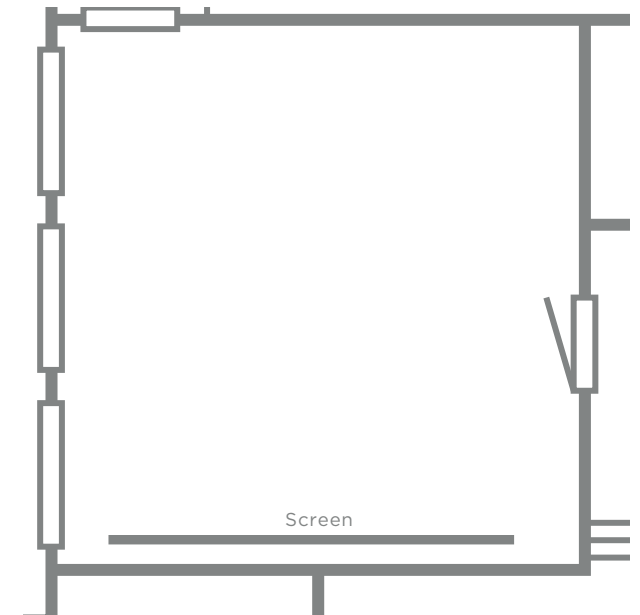

### Dimensions & capacity

Surface (m <sup>2</sup> /ft <sup>2</sup> )	60/645								
Length (m)	8.0	Theatre	Banquet	Crescent	Class-room	Square	Board-room	U-shape	Cocktail
Width (m)	7.5								
Height (m)	5.0								
St. Cecilia Chamber		50	40	21	27	32	20	24	60





Photo credits: Kaan Sensoy

Main building - First floor

## Aldermans Chamber

The stunning historical Aldermans Chamber has been used, up until 1992, as the Mayor's meeting office. Besides this unique role in Amsterdam's history, the room offers a spectacular view over one of the oldest canals in Amsterdam and will ensure to give your guests a unique and lasting experience.

- Built-in projection screen of 2,40 x 1,75 m
- Natural daylight
- Adjustable lightning
- Air-conditioned and windows that can be opened

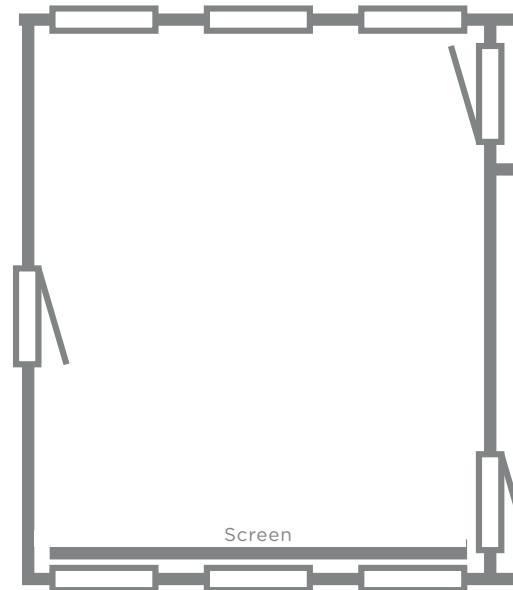

Dimensions & capacity									
Surface (m <sup>2</sup> /ft <sup>2</sup> )	57/613								
Length (m)	8.1								
Width (m)	7.0								
Height (m)	3.0								
Aldermans Chamber		40	40	21	24	24	20	24	60



THE GRAND



Main building - First floor

## Burgomaster Chamber

Until 1992, the Burgomaster Chamber was used as office by the former mayors of Amsterdam. It offers a unique setting for meetings and private dinners. The large windows offer a stunning view overlooking one of the capital's oldest canals with its iconic Amsterdam canal houses.

- Built-in projection screen of 2,40 x 1,75 m
- Natural daylight
- Adjustable lightning
- Air-conditioned and windows that can be opened

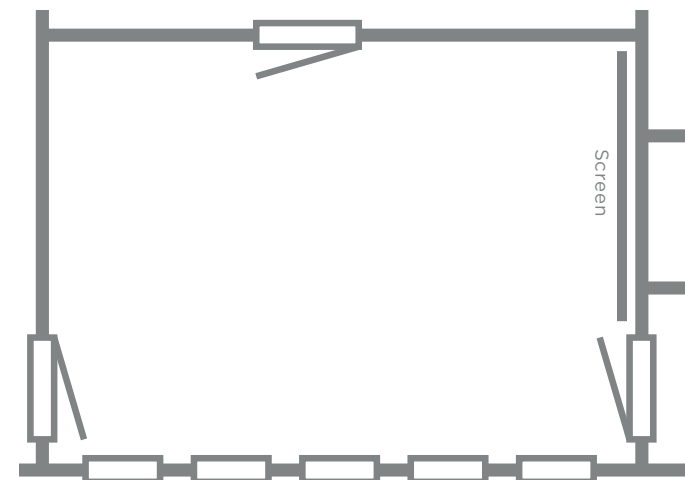

### Dimensions & capacity

Surface (m <sup>2</sup> /ft <sup>2</sup> )	43/462					
Length (m)	8.2	Theatre	Banquet	Board-room	Class-room	Cocktail
Width (m)	5.3					
Height (m)	3.0					
Burgomaster Chamber		30	30	20	18	40

# Princenhof

Ground floor

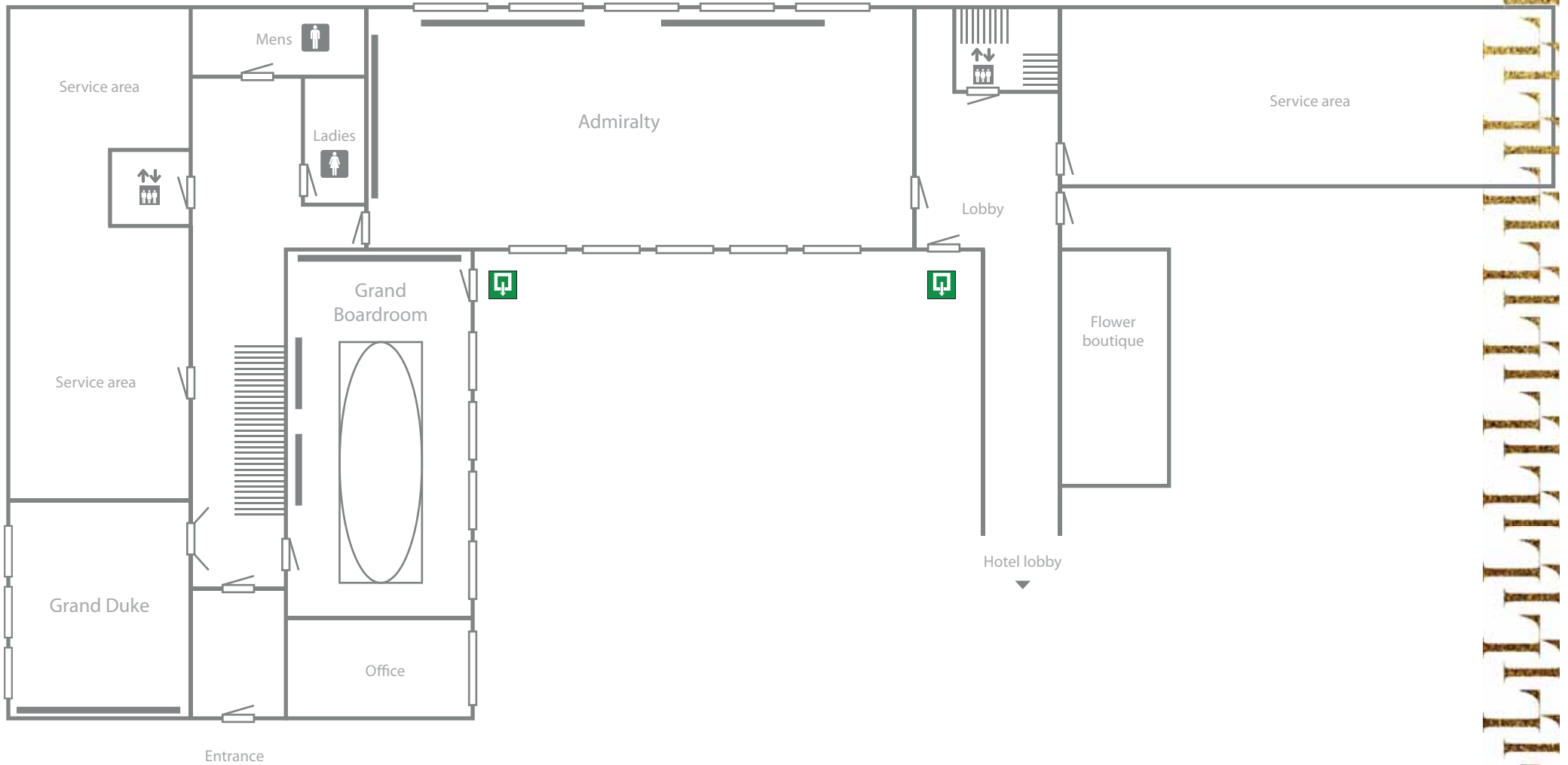





Princenhof - Ground floor

## Admiralty

The Admiralty is located on the ground floor of the Princenhof. The room displays a stylish palette of grey and pink colours and has high windows, from which you can see the courtyard of The Grand and the breathtaking hotel facade. The Admiralty is designed to cater lunch/dinner up to 100 people and exclusive standing receptions up to 150 people. During summer, the Admiralty can be combined with the courtyard of The Grand.

- 3 built-in projectors and projection screens of 2,40 x 1,75 m
- Built-in audio system
- Natural daylight
- Adjustable lightning and blinds
- Air-conditioned

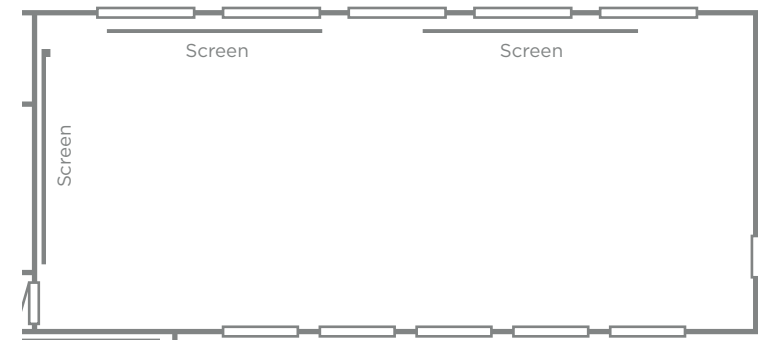

### Dimensions & capacity

Surface (m <sup>2</sup> /ft <sup>2</sup> )	144/1550					
Length (m)	19.0	Theatre	Banquet	Crescent	Board-room	Cocktail
Width (m)	7.6					
Height (m)	3.7					
Admiralty	110	100	56	40	150	



Princenhof - Ground floor

## Grand Boardroom

The Grand Boardroom is a state-of-the-art meeting facility that features contemporary comfort combined with the latest technology, such as video-conference and built-in audiovisual equipment. The spacious Grand Boardroom overlooks the historical courtyard of The Grand and can be combined with the Grand Duke as a private catering location. The Grand Boardroom offers the perfect combination of a rich historical setting with French Art de Vivre style.

- Built-in projection screen of 2,40 x 1,75 m
- 2 extra projection screens
- Natural daylight
- Adjustable lightning and blinds
- Air-conditioned and windows that can be opened
- Power socket, VGA and internet access integrated in the table
- Soundproof

### Dimensions & capacity

Surface (m <sup>2</sup> /ft <sup>2</sup> )	56/602	
Length (m)	9.7	
Width (m)	5.8	
Height (m)	4.2	
Grand Boardroom		Boardroom
		18

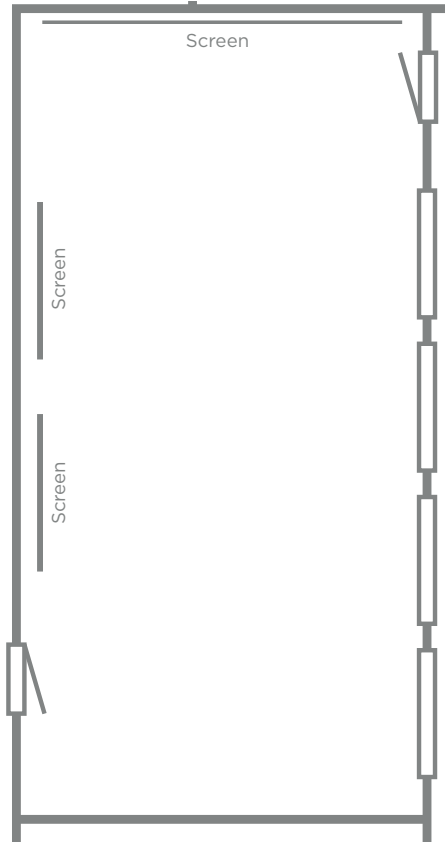

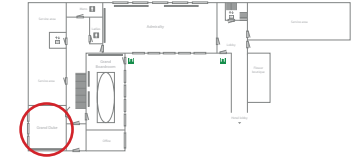

Princenhof - Ground floor

## Grand Duke

The Grand Duke is located on the ground floor, next to the imposing entrance of the Princenhof. The room has large windows to ensure natural daylight and overlooks one of Amsterdam's most beautiful canals with typical Dutch houses.

- Built-in projector and projection screen of 2,40 x 1,75 m
- Built-in audio system
- Natural daylight
- Adjustable lightning and curtains
- Air-conditioned

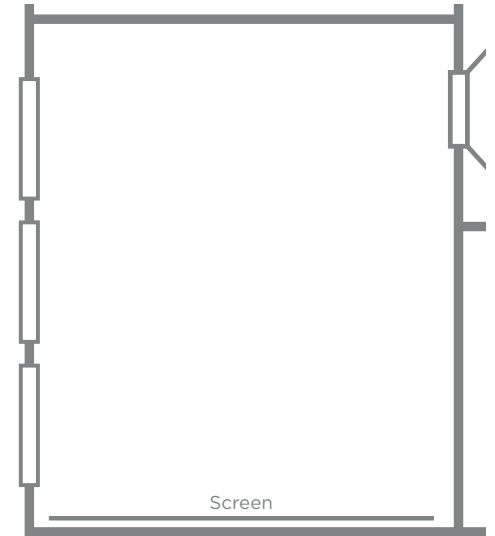

### Dimensions & capacity

Surface (m <sup>2</sup> /ft <sup>2</sup> ) Length (m) Width (m) Height (m)	39/419								
	6.7 5.9 3.6	Theatre	Banquet	Crescent	Class-room	Square	Board-room	U-shape	Cocktail
Grand Duke		30	20	14	12	16	12	12	30



# Princenhof

First floor

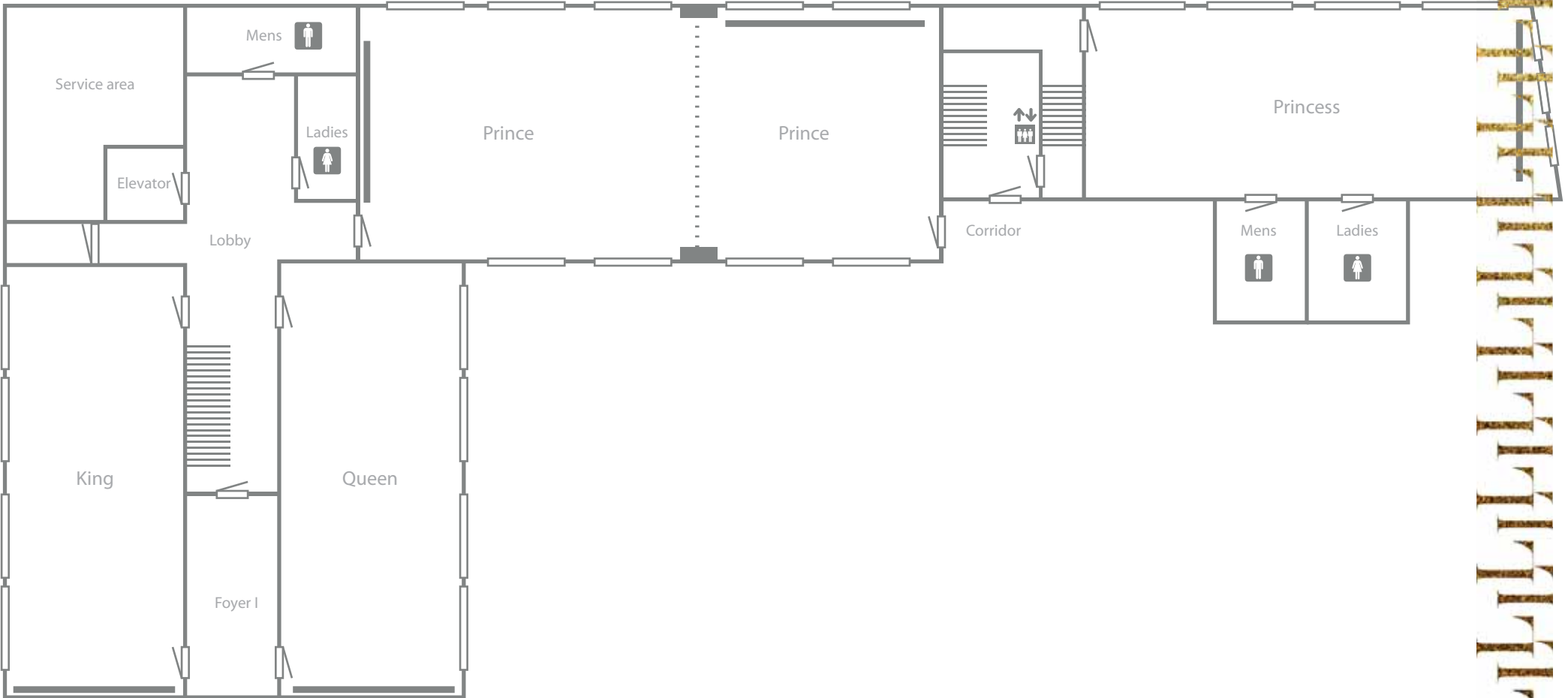



Princenhof - First floor







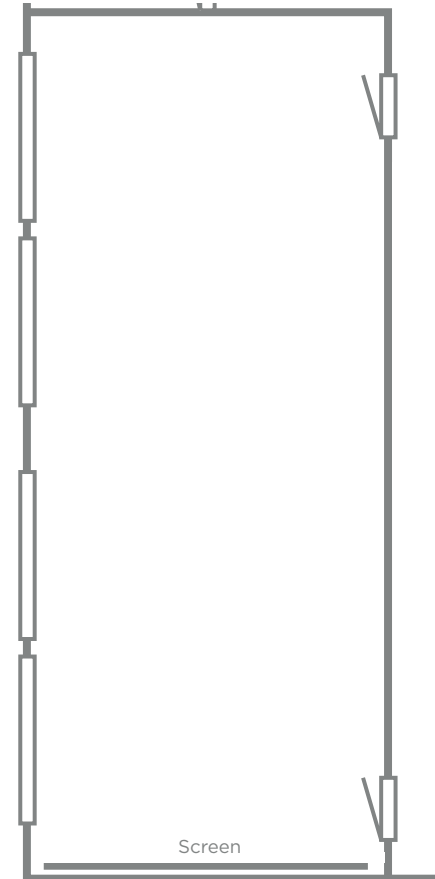
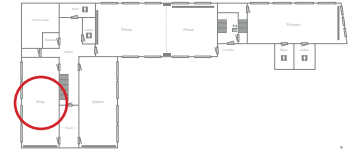

## King

The King is located on the first floor of the beautiful Princenhof. This spacious state-of-the-art meeting room is equipped with all the necessary modern comfort and audiovisual equipment. It is located on the exact opposite of the Queen, separated by a foyer. The King has large windows ensuring natural daylight and providing a unique view over the Amsterdam canals. Additionally, the King boasts wonderful high ceilings and can accommodate a maximum of 80 guests in theatre setup.

- Built-in projector and projection screen of 3,00 x 2,25 m
- Built-in audio system
- Natural daylight
- Adjustable lightning and blinds
- Air-conditioned



### Dimensions & capacity

Surface (m <sup>2</sup> /ft <sup>2</sup> )	94/1011								
Length (m)	15.2	Theatre	Banquet	Cabaret 5 pax/table	Class- room	Square	Board- room	U-shape	Cocktail
Width (m)	6.2								
Height (m)	3.8								
King		80	48	30	30	26	28	32	100



Princenhof - First floor







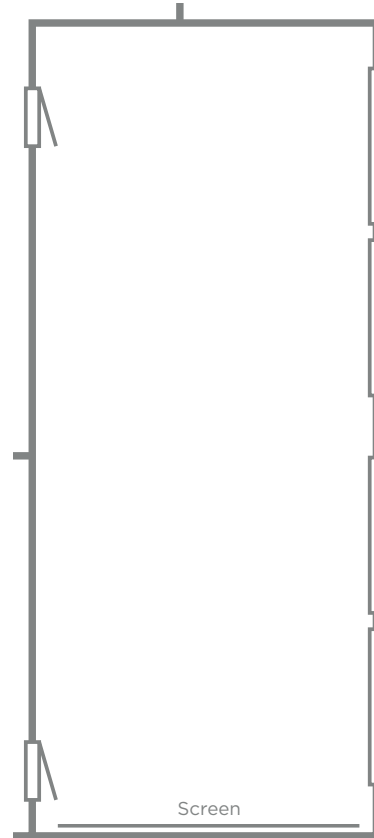

## Queen

The Queen is located on the first floor of the Princenhof. This spacious and bright meeting room is equipped with all the necessary modern comfort and audiovisual equipment. It is located on the exactly opposite of the King, separated by a foyer. The Queen has a wonderful view over the Amsterdam canals, boasts high ceilings and can accommodate a maximum of 80 guests in theatre setup.

- Built-in projector and projection screen of 3,00 x 2,25 m
- Built-in audio system
- Natural daylight
- Adjustable lightning and blinds
- Air-conditioned



### Dimensions & capacity

Surface (m <sup>2</sup> /ft <sup>2</sup> )	85/914								
Length (m)	13.8	Theatre	Banquet	Cabaret 5 pax/table	Class- room	Square	Board- room	U-shape	Cocktail
Width (m)	6.2								
Height (m)	3.2								
Queen		80	48	30	30	26	28	32	100













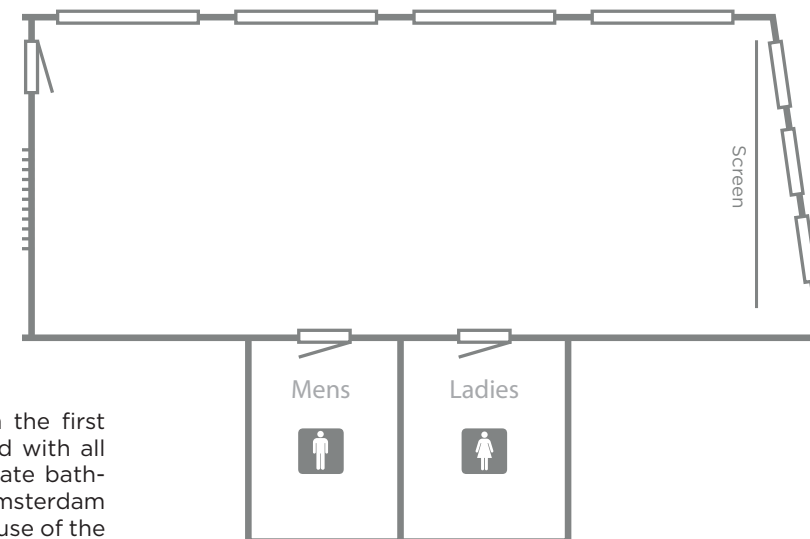

Princenhof - First floor

## Princess

The Princess is a spacious room, located on the first floor of the Princenhof. The room is equipped with all the necessary modern comforts and has private bathroom facilities. The Princess overlooks the Amsterdam canals and offers a lot of natural daylight because of the large windows on two sides of the room.

- Built-in projector and projection screen of 2,90 x 1,80 m
- Built-in audio system
- Natural daylight
- Adjustable lightning and blinds
- Air-conditioned



Dimensions & capacity								
Surface (m <sup>2</sup> /ft <sup>2</sup> )	104/1119							
Length (m)	17.4	Theatre	Cabaret 5 pax/table	Class-room	Square	Board-room	U-shape	Cocktail
Width (m)	6.0							
Height (m)	2.8							
Princess		80	30	30	26	28	28	100

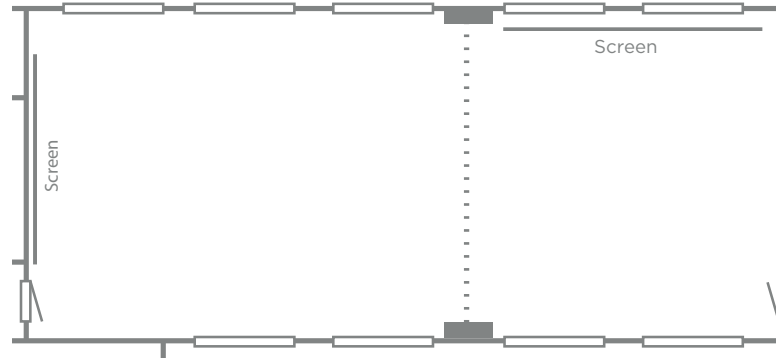
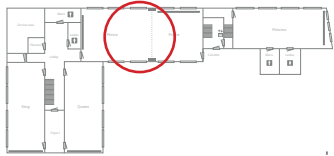

Princenhof - First floor

## Prince

The Prince is situated on the first floor of the Princenhof and fitted with built-in audio-visual equipment. The Prince overlooks the courtyard of The Grand and can be divided into two separate rooms by a sliding wall. Prince I has a total of 90.4 m<sup>2</sup> and Prince II a total of 64.6 m<sup>2</sup>.

- Built-in projector and projection screen of 4,00 x 2,24 m
- Built-in audio system
- Natural daylight
- Adjustable lightning and blinds
- Air-conditioned

Dimensions & capacity		Theatre	Banquet	Cabaret 5 pax/table	Class- room	Square	Board- room	U-shape	Cocktail
Surface (m <sup>2</sup> /ft <sup>2</sup> )	155/1668								
Length (m)	19.4								
Width (m)	8.0								
Height (m)	3.3								
Prince		150	80	75	72	54	40	46	150
Prince I		100	50	45	45	36	30	32	90
Prince II		50	30	30	27	24	14	16	60



Princenhof



**Princenhof**  
Second floor





Princenhof - Second floor

## Earl

The Earl is a boardroom with fixed setup on the second floor of the Princenhof. It has a central control panel that enables guests to control the lights, air-conditioning, etc in the room. The Earl can easily be combined with the other boardrooms on the floor.

- Built-in 52" HD plasma screen
- Natural daylight
- Adjustable lightning and curtains
- Air-conditioned
- Power socket, VGA and internet access integrated in the table

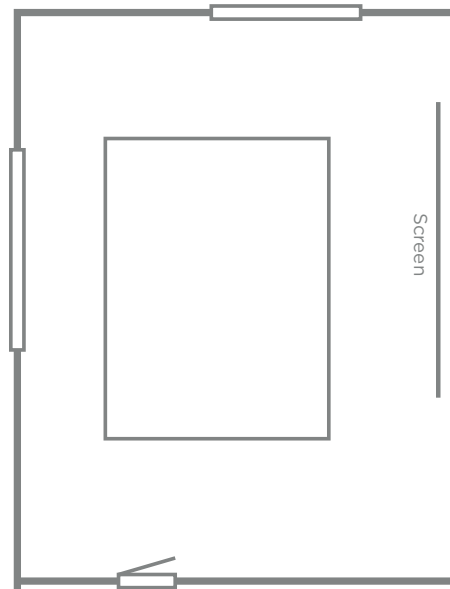

### Dimensions & capacity

Surface (m <sup>2</sup> /ft <sup>2</sup> )	28/301	■■■■	Board-room
Length (m)	6.0	■■■■	
Width (m)	4.7	■■■■	
Height (m)	2.8		
Earl	5 <sup>a</sup> /8 <sup>b</sup>	<sup>a</sup> With screen <sup>b</sup> Without screen	



Princenhof - Second floor

## Count

The Count is a boardroom with fixed setup on the second floor of the Princenhof. It has a central control panel that enables guests to control the lights, air-conditioning, etc in the room. The Count can easily be combined with the other boardrooms on the floor.

- Built-in 65" HD plasma screen
- Natural daylight
- Adjustable lightning and curtains
- Air-conditioned
- Power socket, VGA and internet access integrated in the table

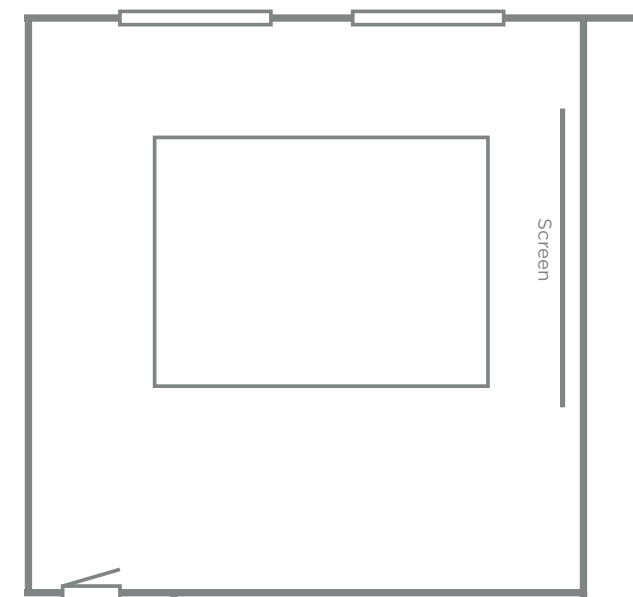

### Dimensions & capacity

Surface (m <sup>2</sup> /ft <sup>2</sup> )	38/409	■ ■ ■ ■
Length (m)	6.5	■ ■ ■ ■
Width (m)	5.9	■ ■ ■ ■
Height (m)	2.8	Board-room
Count	14 <sup>A</sup> /16 <sup>B</sup>	<sup>A</sup> With screen <sup>B</sup> Without screen

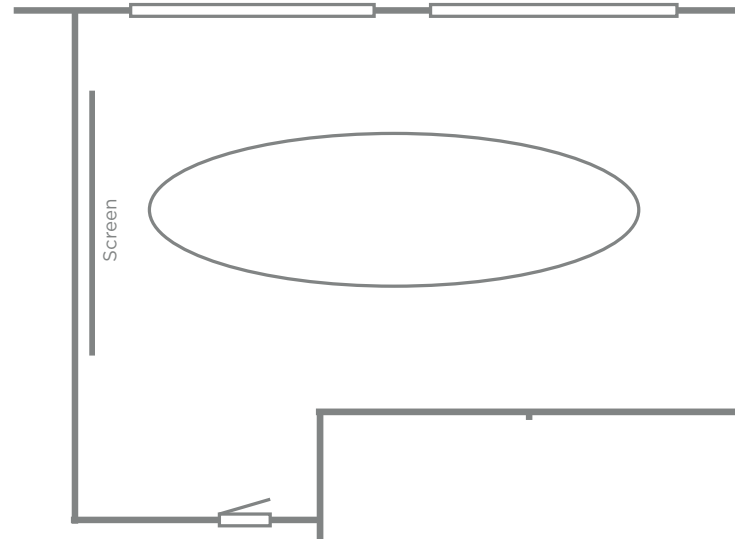

Princenhof - Second floor

## Baron

The Baron is a boardroom with fixed setup on the second floor of the Princenhof. It has a comfortable lounge area next to the boardroom table.

- Built-in projector and projection screen of 2,4 x 1,75 m
- Natural daylight
- Adjustable lightning
- Air-conditioned
- Power socket, VGA and internet access integrated in the table

Dimensions & capacity		
Surface (m <sup>2</sup> /ft <sup>2</sup> )	43/462	■■■■
Length (m)	9.5	■■■■
Width (m)	4.6	■■■■
Height (m)	2.8	Board-room
Baron	10 <sup>a</sup> /12 <sup>b</sup>	<sup>a</sup> With screen <sup>b</sup> Without screen







Princenhof - Second floor



## Marquis

The Marquis is a boardroom with fixed setup on the second floor of the Princenhof. It has a central control panel that enables guests to control the lights, air-conditioning, etc in the room. The Marquis can easily be combined with the other boardrooms on the floor.

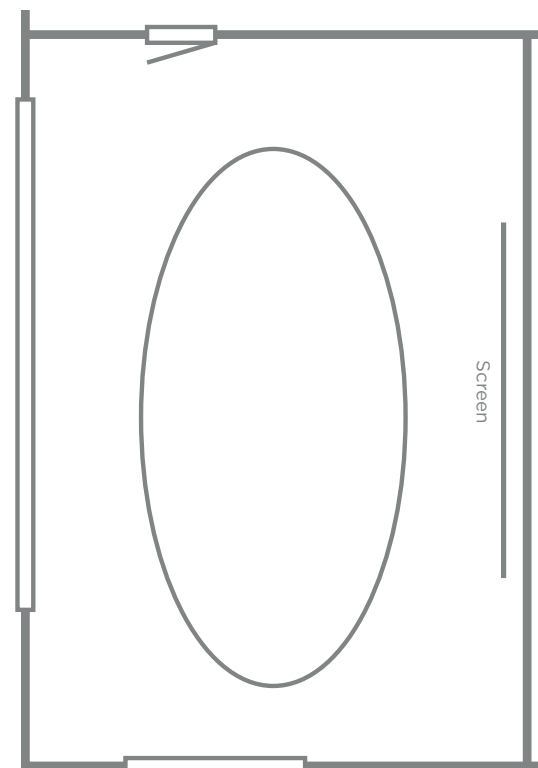
- Built-in 52" HD plasma screen
- Natural daylight
- Adjustable lightning and curtains
- Air-conditioned
- Power socket, VGA and internet access integrated in the table



### Dimensions & capacity

Surface (m <sup>2</sup> /ft <sup>2</sup> )	28/301	   Board-room
Length (m)	6.0	
Width (m)	4.7	
Height (m)	2.7	
Marquis	8 <sup>A</sup> /10 <sup>B</sup>	<sup>A</sup> With screen <sup>B</sup> Without screen

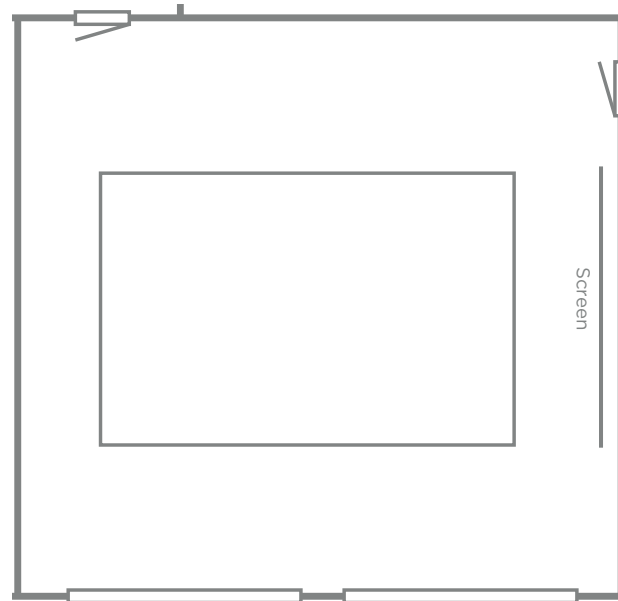

Princenhof - Second floor

## Lord

The Lord is a boardroom with fixed setup on the second floor of the Princenhof. It has a central control panel that enables guests to control the lights, air-conditioning, etc in the room. The Lord can easily be combined with the other boardrooms on the floor.

- Built-in 65" HD plasma screen
- Natural daylight
- Adjustable lightning and curtains
- Air-conditioned
- Power socket, VGA and internet access integrated in the table

### Dimensions & capacity

Surface (m <sup>2</sup> /ft <sup>2</sup> )	42/452	■■■■	Board-room
Length (m)	7.2	■■■■	
Width (m)	5.9	■■■■	
Height (m)	2.7		
Lord	14 <sup>a</sup> /16 <sup>b</sup>	<sup>a</sup> With screen <sup>b</sup> Without screen	





19 meeting rooms, including 5 historical rooms  
All with natural daylight and air-conditioning  
7 private dining rooms

177 guestrooms, including 52 suites with butler service

2 restaurants & 3 bars  
Bridges, including private dining  
Oriole  
The Flying Dutchman  
Library 'Or'

Sofitel SPA & Sofitel FITNESS | Valet parking | Free Wi-Fi

MAGNIFIQUE  
MEETINGS

Sofitel Legend The Grand Amsterdam - Oudezijds Voorburgwal 197 - 1012 EX Amsterdam - T :31(0)20 555 31 11  
[www.sofitel-legend-thegrand.com](http://www.sofitel-legend-thegrand.com)

  SofitelLegendTheGrandAmsterdam   BridgesAmsterdam   OrioleBistro

SOFITEL  
LEGEND